



# DATA 2

Self-contained addressable system



## PARAMETERS

Max. number of emergency fittings / channel	64
Maximum number of communication channels	4
Maximum number of C-Bridge 2 signal distributor	16
Max. number of emergency fittings in the system	4096
Material	blacha malowana proszkowo, RAL 9003
Protection degree	IP30
Insulation class	I

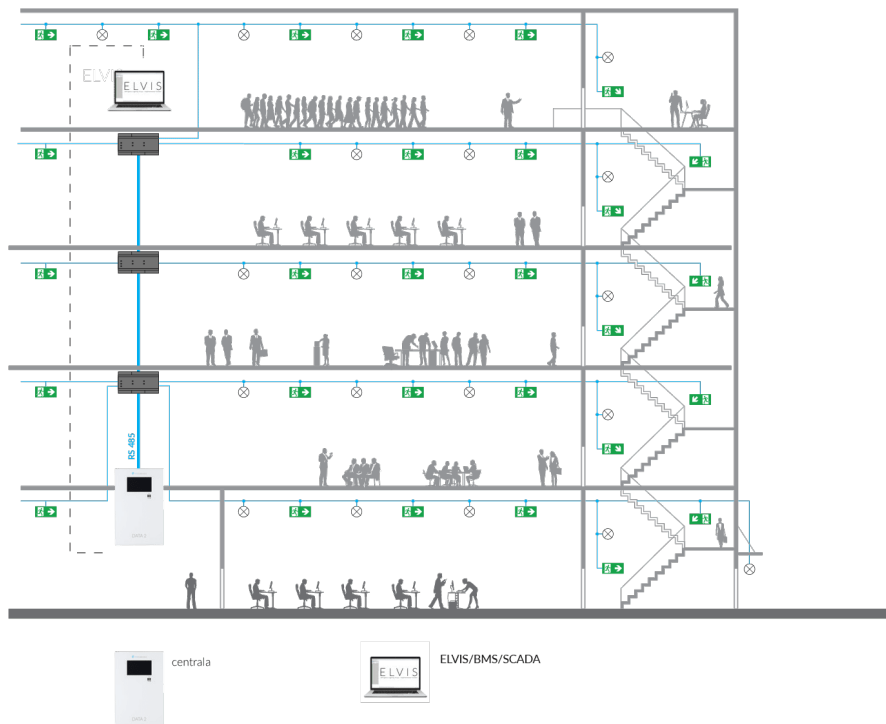

# SYSTEM COMPONENTS

## C-BRIDGE 2

Intermediary device for communication between the controller and DATA 2 series addressable devices. The control panel is equipped with one splitter as a standard, but optionally it is possible to connect a second signal splitter, thus increasing the maximum possible number of luminaires to 4096.



Supply voltage	22-25 V DC
Communication speed	RS-485: 19200 bit/s
Bus voltage	15-25 V
Bus communication speed	5 kbit/s
Insulation class	III

## I/O MODULE

Device enabling control of emergency lighting groups, dedicated to DATA 2, DATA 2 RADIO and TM-CB emergency lighting systems. IN input and OUT output models are available. The DATA 2, DATA 2 RADIO and TM-CB system allows the connection of up to 16 I/O modules. The address of each module is set on DiP-switches on their housing. IN SW, IN 24, IN 230 version is used to control the night lighting, fire-emergency lighting groups, fire scenarios and has 8 inputs. The output module (OUT) is used to inform about the system status. It has 8 potential-free outputs.



## WIRING

Communication with controller	RS 485 port
Communication with ELVIS, WWW, MODBUS TCP	LAN
Communication with addressable devices	TM-BUS 2-wire data bus (without polarity) - communication cable, for example: YTKSYekw 1 x 2 x 0.8 mm <sup>2</sup> or other wires complying with the parameters: length: max. up to 1,000 m operating temperature: -15°C to + 70°C resistance: max. 75 Ω/km conductor capacity: max. 120 nF/km



## \*ELVIS

Emergency Lighting Visualization System

An additional facilitation in the management of emergency lighting luminaires is the software that visualizes the arrangement of luminaires on the actual plan of the building. It enables remote management and testing of emergency lighting fittings, as well as generating and downloading reports required by law.

\*optional element of the system



#### \*TM-PROG RFID



TM-PROG RFID is a programming device used to read and addresses of lighting fittings that are compliant with TM-CB A or DATA 2 /DATA 2 EASY system.

- » Programming is executed in a wireless mode that provides for operation without connecting lighting fittings to a power supply.
- » The programming device has a built-in battery that offers long operating time, and the current consumption is shown on a display.
- » The programming device has an ergonomic casing that protects the device against mechanical damage and prevents accidental slipping from the hand.

\*optional element of the system

